

# Cafe Booster

## USER MANUAL



### Child Restraint Operation

Press center to unlock

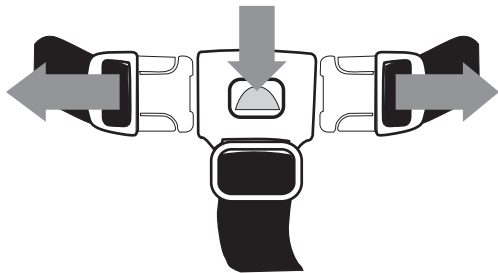

Insert tabs to lock

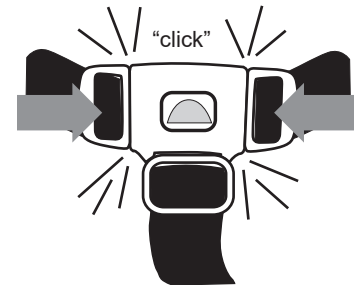

### Chair Attachment Straps



Note: Ensure both Attachment Straps thread up through and over booster seat.

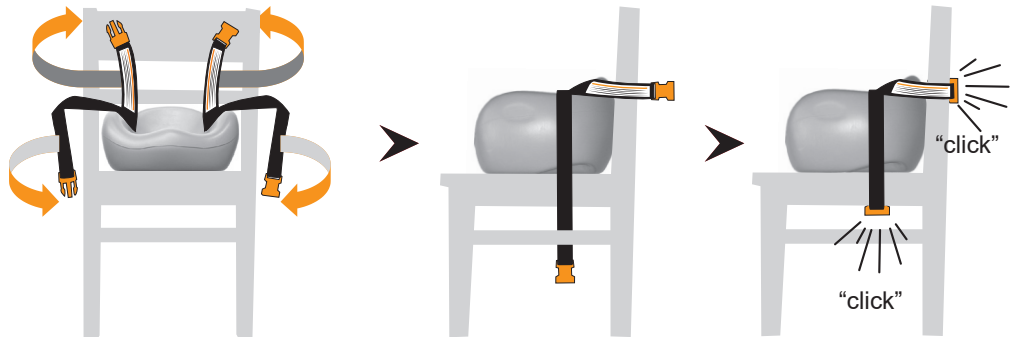

## ⚠️ WARNING:

- CHILDREN HAVE SUFFERED SEVERE HEAD INJURIES INCLUDING SKULL FRACTURES, AFTER FALLING WITH OR FROM BOOSTER SEATS.
- CHECK THAT BOOSTER SEAT IS SECURELY ATTACHED TO ADULT CHAIR BEFORE EACH USE.
- ALWAYS USE RESTRAINTS UNTIL CHILD IS ABLE TO GET IN AND OUT OF BOOSTER SEAT WITHOUT HELP. ADJUST TO FIT SNUGLY.
- NEVER ALLOW CHILD TO PUSH AWAY FROM THE TABLE.
- NEVER LIFT AND CARRY CHILD IN BOOSTER SEAT.
- STAY NEAR AND WATCH YOUR CHILD DURING USE.
- USE THIS PRODUCT ONLY FOR CHILDREN CAPABLE OF SITTING UPRIGHT UNASSISTED.

• ALWAYS USE PROVIDED ATTACHMENT STRAPS TO SECURE BOOSTER SEAT TO ADULT CHAIR. SECURE PRODUCT STRAPS TIGHTLY AROUND SEAT AND BACK OF ADULT CHAIR. AUDIBLE "CLICK" ENSURES SAFE ATTACHMENT. ALWAYS CHECK SECURITY OF FIT TO CHAIR BEFORE EACH USE.

## Specifications

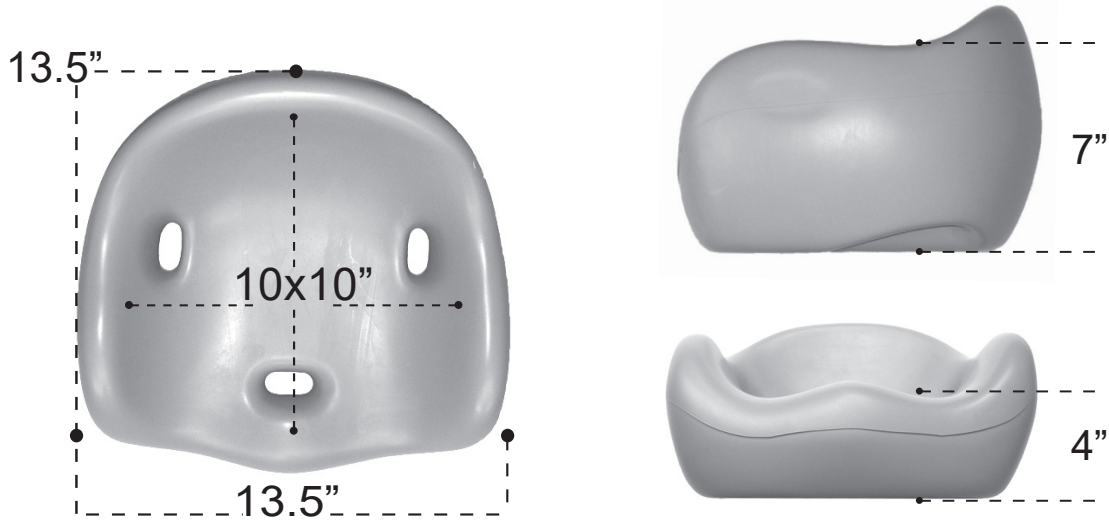

---

### Limited Warranty

Bergeron by Design warrants to the original retail purchaser of the Keekaroo® product, that if any part or component proves defective in material or workmanship within five years of the purchase date, the defective part will be repaired or replaced (at Bergeron by Design's discretion) free of charge. Warranty service may be performed by an authorized service center or (at Bergeron by Design's discretion) the factory.

This warranty does not cover normal wear and tear, or damage caused by accident or misuse.

To exercise this limited warranty, the user should first obtain a Return Authorization Number from the retailer the Keekaroo® product was purchased from. The product must be delivered charges pre-paid (UPS recommended) to the factory or to the retailer, together with a copy of the original invoice, the Return Authorization Number and a written discription of the problem.

---

### Product Care

Keekaroo® Cafe Booster is impermeable to fluids. However, DO NOT SUBMERGE while cleaning. Use a mild detergent to clean periodically.

---

### Customer Service

Contact your retailer or contact us directly:

Keekaroo® Customer Service Support

Toll Free: 1.800.994.2416

International: 1.315.429.7110

Fax: 1.315.429.8862

Email: [support@keekaroo.com](mailto:support@keekaroo.com)

---

### Notice

No part of this document may be photocopied, reproduced, or translated to another language without the prior written consent of Bergeron by Design.

Use only Keekaroo® accessories and parts on Keekaroo® products. Keekaroo® parts are not interchangeable with other manufactures' products. Replace any worn parts immediately for safety. © Bergeron By Design.

---

## WARNING:

- PREVENT SERIOUS INJURY OR DEATH. DO NOT USE IN MOTOR VEHICLES.
- NEVER USE AS A BATH SEAT. THIS PRODUCT IS ONLY INTENDED FOR USE IN A CHAIR AS A BOOSTER. DO NOT USE ON ANY OTHER ELEVATED SURFACE.
- ADULT CHAIR SEAT MUST BE 13.5" WIDE BY 13.5" DEEP. ADULT CHAIR BACK MUST BE OVER 7" TALL.



JPMA



Bergeron By Design  
15 South Second St.  
Dolgeville, NY 13329  
1.866.529.8407